

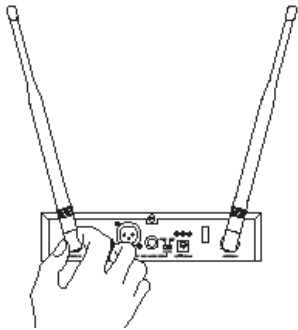

R300

UHF WIRELESS MICROPHONE – Handheld Transmitter

QUICK START GUIDE



1. Install Antennas

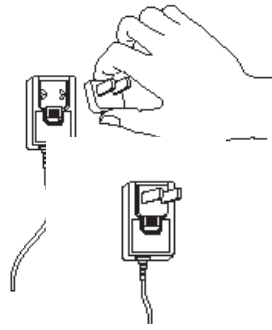

2. Install AC Adapter Blades



3. Plug in Receiver

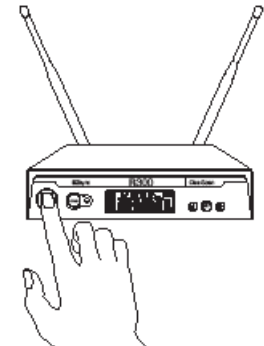

4. Turn on Receiver

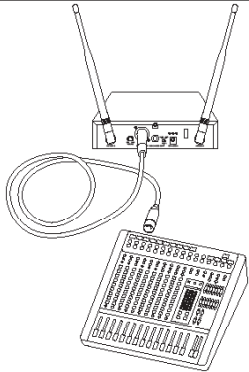

5. Plug Receiver into Audio System

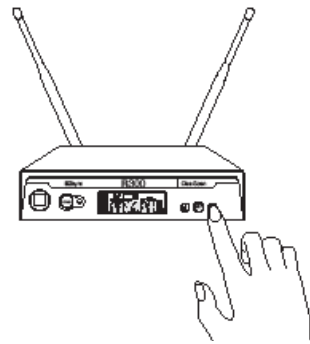

6. Press and Hold ► Until CLEARSCAN Appears

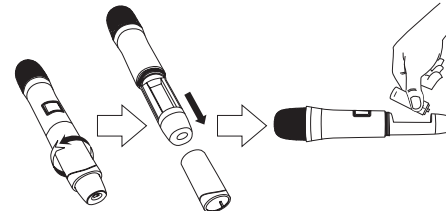

7. Install Batteries in Transmitter

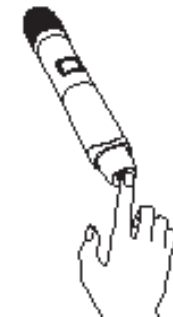

8. Turn on Transmitter

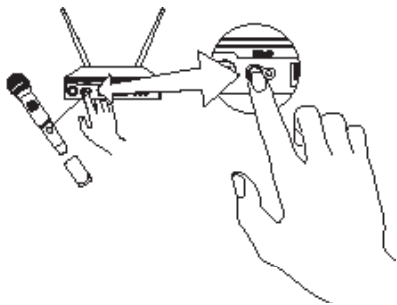

9. EZSync Transmitter

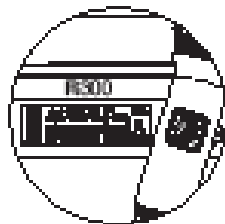

10. Verify Reception

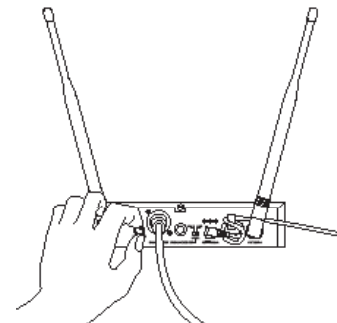

11. Adjust Gain



12. Start Using the R300



R300

UHF WIRELESS MICROPHONE – Bodypack Transmitter

QUICK START GUIDE

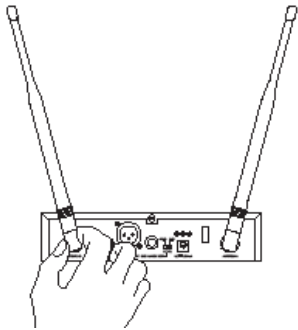

1. Install Antennas

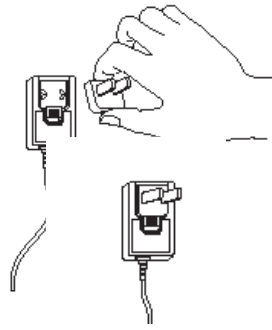

2. Install AC Adapter Blades



3. Plug in Receiver

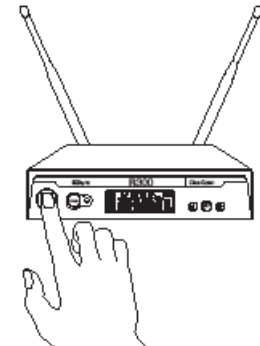

4. Turn on Receiver

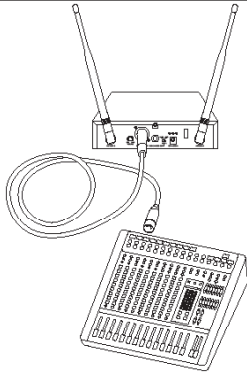

5. Plug Receiver into Audio System

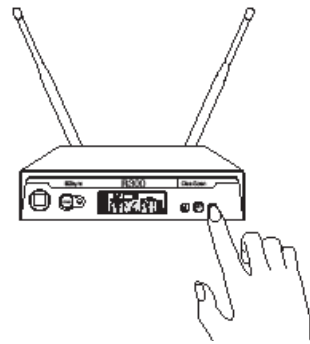

6. Press and Hold ► Until CLEARSCAN Appears

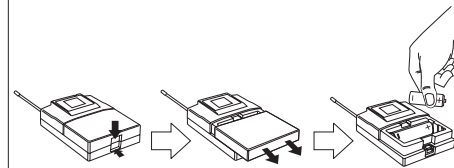

7. Install Batteries in Transmitter

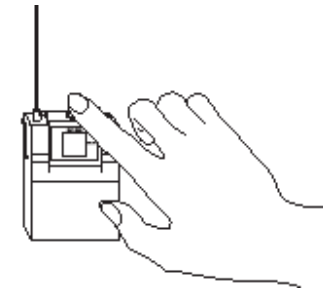

8. Turn on Transmitter

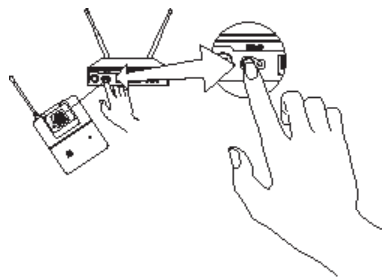

9. EZSync Transmitter

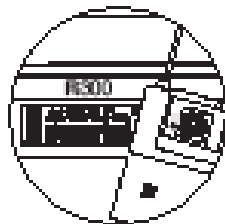

10. Verify Reception

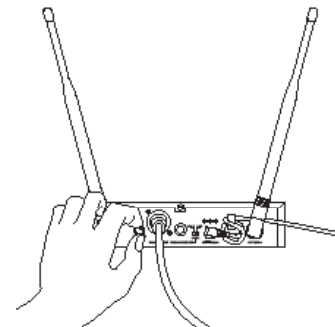

11. Adjust Gain



12. Start Using the R300